



SH

Maximum Security Surface Mount Fluorescent Wall

PRODUCT SPECIFICATION

The SH series is designed for wall mount direct / indirect cell lighting in medium, maximum and super max security detention facilities.

Mounting

Surface mounts to wall.

Clamshell Housing

One piece, die-formed cold rolled steel with seams welded and ground smooth, 14 gauge lens retainers and a full length, welded pin piano hinge. Stainless steel available.

Back Plate

16 gauge die-formed cold rolled steel with embossed mounting holes to create a contraband drop slot / irretrievable blade trap.

Finish

Polyester powder-coated after phosphate pretreatment for superior adhesion and corrosion resistance. Brushed stainless steel available.

Hardware

Recessed, stainless steel, tamper-proof fasteners.

Wiring

Reflector-mounted electrical components for easy wiring and maintenance.

Certifications

UL Listed damp or wet location. Covered ceilings only.

Job Name _____

Fixture Type _____

Catalog No. _____

Approval _____ Date _____

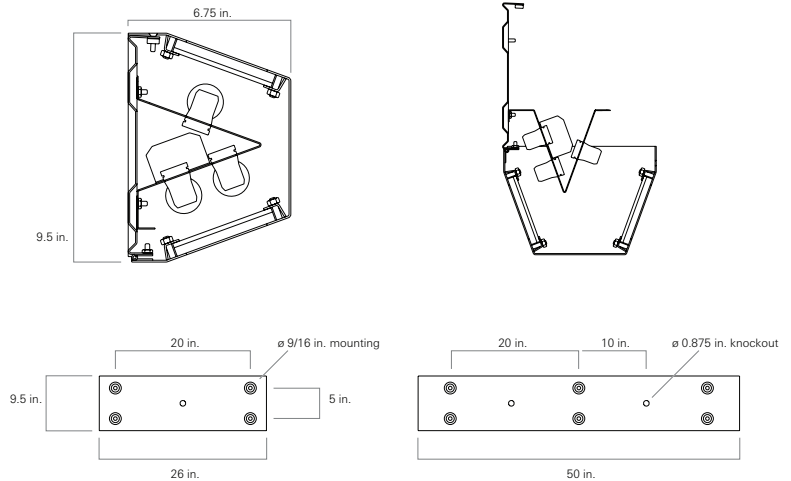

<p>one Uplight lamps (not included)</p> <p>14 2 ft. 14 W T5</p> <p>17 2 ft 17 W T8</p> <p>24 2 ft. 24 W T5 HO</p> <p>4B 2ft. 40 W T5 RS biax</p> <p>28 4 ft. 28 W T5</p> <p>32 4 ft. 32 W T8</p> <p>54 4 ft. 54 W T5 HO</p> <p>two Uplight Lamp Quantity</p> <p>1 one</p> <p>2 two</p> <p>three Downlight Lamps (not included)</p> <p>14 2 ft. 14 W T5</p> <p>17 2 ft 17 W T8</p> <p>24 2 ft. 24 W T5 HO</p> <p>4B 2ft. 40 W RS T5 biax</p> <p>28 4 ft. 28 W T5</p> <p>32 4 ft. 32 W T8</p> <p>54 4 ft. 54 W T5 HO</p> <p>four Downlight Lamp Quantity</p> <p>1 one</p> <p>2 two</p> <p>five Housing Gauge</p> <p>N 18 gauge, minimum security</p> <p>D 16 gauge, medium security</p> <p>X 14 gauge, maximum security</p> <p>U 12 gauge, super max, <u>CRS only</u></p>	<p>six Housing Material</p> <p>C Cold rolled steel</p> <p>S Stainless steel</p> <p>seven Finish</p> <p>R Brushed stainless steel</p> <p>W White</p> <p>eight Voltage</p> <p>120 120 V, 60 Hz</p> <p>277 277 V, 60 Hz</p> <p>347 347 V, 60 Hz</p> <p>VAR Variable, 120-277 V, 50/60Hz</p> <p>nine Ballast</p> <p>DM Dimming</p> <p>EL Electronic Instant Start, <u>std T8</u></p> <p>PR Program Rapid Start, <u>std T5, option T8</u></p> <p>ten Internal Lens</p> <p>53 .125 in. K12 prismatic acrylic</p> <p>12 .125 in. K12 prismatic polycarbonate</p> <p>15 .156 in. K12 prismatic polycarbonate</p> <p>16 .187 in. K12 prismatic polycarbonate</p> <p>75 .156 in. C73 prismatic tempered glass</p> <p>01 .005 in. UV absorbing overlay</p>	<p>eleven External Lens</p> <p>30 .187 in. clear polycarbonate</p> <p>32 .250 in. clear polycarbonate</p> <p>36 .375 in. clear polycarbonate</p> <p>38 .500 in. clear polycarbonate</p> <p>90 .187 in. clear tempered glass</p> <p>92 .250 in. clear tempered glass</p> <p>96 .375 in. clear tempered glass</p> <p>twelve Door Fasteners</p> <p>AP Stainless steel allen head with pin</p> <p>TP Stainless steel torx head with pin</p> <p>PH Phillips, non-security</p> <p>thirteen Electrical Access</p> <p>A 2.250 in. diameter access hole</p> <p>K 0.875 in. diameter knockout(s), <u>std</u></p> <p>fourteen UL Listing</p> <p>D Damp Location</p> <p>W Wet Location</p> <p>fifteen Options</p> <p>2C Two-circuit wired</p> <p>CU Canadian UL Listing</p> <p>E1 One lamp emergency ballast</p> <p>E2 Two lamp emergency ballast</p> <p>FH Fuse and holder</p> <p>NL Night light, for 7 or 9 W PL bipin</p> <p>NL-LED Night light, LED</p> <p>IMS Integral Occ Sensor</p> <p>PS Security push on/off switch</p>
--	--	---

Modifications are available to meet custom requirements.