



PRODUCT SPECIFICATION

The SG series is designed for use in all levels of security facilities and high abuse applications.

Mounting

Surface mounts to corner or wall.

Housing

Die-formed cold rolled steel with seams welded and ground smooth. Stainless steel available.

Door

One piece, die-formed cold rolled steel door with 14 gauge lens retainers and a full length welded pin piano hinge. Stainless steel available.

Internal Lens

Optic Plus lens (standard) completely hides diode image while providing minimum 95% light transmission.

Finish

Polyester powder-coated after phosphate pretreatment for superior adhesion and corrosion resistance. Brushed stainless steel available.

Hardware

Recessed, stainless steel, tamper-proof fasteners.

Driver

0-10Vdc dimming, Range 10%-100%
-40°C Min. starting temperature, >0.9 PF, <20% THD.

Wiring

Driver provided with pre-wired 3-wire self-aligning input power quick disconnect and 2-wire quick disconnect to LED module.

Job Name _____

Fixture Type _____

Catalog No. _____

Approval _____

Date _____

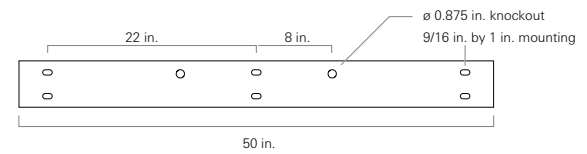
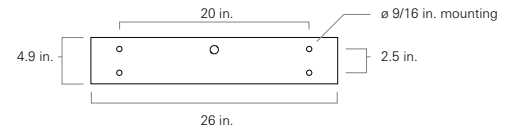
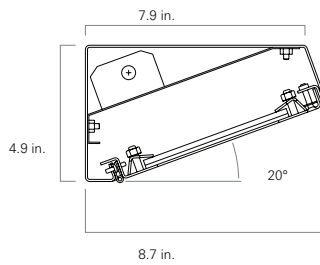

Certifications

UL Listed damp or wet location. IP54 rated. Covered ceilings only.



one Luminaire Size
2 2 ft fixture
4 4 ft fixture

two LED Rows
1L One
2L Two

three Color Temperature
35 3500K
40 4000K
50 5000K

four Material Gauge
N 18 gauge, minimum security
D 16 gauge, medium security
X 14 gauge, maximum security

five Material
C Cold rolled steel
S Stainless steel

six Finish
R Brushed stainless steel
W White

seven Voltage
120 120 V, 60 Hz
277 277 V, 60 Hz
VAR Variable, 120-277 V, 50/60Hz

eight Driver
DM 0-10Vdc Dimming, standard

nine Internal Lens
122 Optic Plus LED diffusing acrylic lens, std
53 .125 in. K12 prismatic acrylic
12 .125 in K12 prismatic polycarbonate
15 .156 in. K12 prismatic polycarbonate
16 .187 in. K12 prismatic polycarbonate
75 .156 in. C73 prismatic tempered glass

ten External Lens
30 .187 in. clear polycarbonate
32 .250 in. clear polycarbonate
36 .375 in. clear polycarbonate
38 .500 in. clear polycarbonate
90 .187 in. clear tempered glass
92 .250 in. clear tempered glass
96 .375 in. clear tempered glass

eleven Door Fasteners
AP Stainless steel allen head with pin
TP Stainless steel torx head with pin
PH Phillips head, non-security

twelve Mounting Holes
D Ceiling and wall mounting holes
W Wall mounting holes only

thirteen Electrical Access
A 2.250 in. diameter access hole
K 0.875 in. diameter knockout(s), std

fourteen UL Listing
D Damp Location
W Wet Location

fifteen Options
SO Specified output*
2C Two-circuit wired
CU Canadian UL Listing
EM Emergency battery backup
FH Fuse and holder
NL-LED Night light, LED
IMS Integral Occ Sensor
PS Security push on/off switch

* Indicated as SO(xx/xxxx). Specified output, Input watts / delivered lumens to be determined based on specified requirements

Modifications are available to meet custom requirements.