



PRODUCT SPECIFICATION

The SG series is designed for use in all levels of security facilities and high abuse applications.

**Mounting**

Surface mounts to corner or wall.

**Housing**

Die-formed cold rolled steel with seams welded and ground smooth. Stainless steel available.

**Door**

One piece, die-formed cold rolled steel door with 14 gauge lens retainers and a full length welded pin piano hinge. Stainless steel available.

**Finish**

Polyester powder-coated after phosphate pretreatment for superior adhesion and corrosion resistance. Brushed stainless steel available.

**Hardware**

Recessed, stainless steel, tamper-proof fasteners.

**Wiring**

All electrical components are reflector-mounted for easy wiring and maintenance.

**Certifications**

UL Listed damp or wet location. Covered ceilings only.

Job Name \_\_\_\_\_

Fixture Type \_\_\_\_\_

Catalog No. \_\_\_\_\_

Approval \_\_\_\_\_ Date \_\_\_\_\_

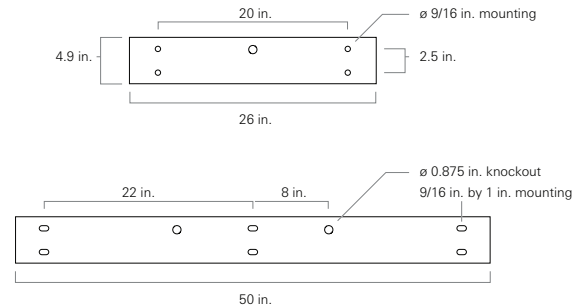
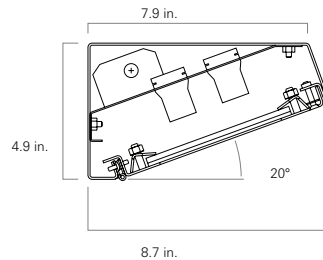

<b>one</b>	<b>Lamps (not included)</b>
14	2 ft. 14 W T5
17	2 ft. 17 W T8
24	2 ft. 24 W T5 HO
4B	2 ft. 40 W T5 biax
28	4 ft. 28 W T5
32	4 ft. 32 W T8
54	4 ft. 54 W T5 HO

<b>two</b>	<b>Lamp Quantity</b>
1	One
2	Two

<b>three</b>	<b>Material Gauge</b>
N	18 gauge, minimum security
D	16 gauge, medium security
X	14 gauge, maximum security

<b>four</b>	<b>Material</b>
C	Cold rolled steel
S	Stainless steel

<b>five</b>	<b>Finish</b>
R	Brushed stainless steel
W	White

<b>six</b>	<b>Voltage</b>
120	120 V, 60 Hz
277	277 V, 60 Hz
347	347 V, 60 Hz
VAR	Variable, 120-277 V, 50/60Hz
<b>seven</b>	<b>Ballast</b>
DM	Dimming
EL	Electronic Instant Start, <u>std T8</u>
PR	Program Rapid Start, <u>std T5, option T8</u>
<b>eight</b>	<b>Internal Lens</b>
53	.125 in. K12 prismatic acrylic
12	.125 in. K12 prismatic polycarbonate
15	.156 in. K12 prismatic polycarbonate
16	.187 in. K12 prismatic polycarbonate
75	.156 in. C73 prismatic tempered glass
01	.005 in. UV absorbing overlay
<b>nine</b>	<b>External Lens</b>
30	.187 in. clear polycarbonate
32	.250 in. clear polycarbonate
36	.375 in. clear polycarbonate
38	.500 in. clear polycarbonate
90	.187 in. clear tempered glass
92	.250 in. clear tempered glass
96	.375 in. clear tempered glass

<b>ten</b>	<b>Door Fasteners</b>
AP	Stainless steel allen head with pin
TP	Stainless steel torx head with pin
PH	Phillips head, non-security
<b>eleven</b>	<b>Mounting Holes</b>
D	Ceiling and wall mounting holes
W	Wall mounting holes only
<b>twelve</b>	<b>Electrical Access</b>
A	2.250 in. diameter access hole
K	0.875 in. diameter knockout(s), <u>std</u>
<b>thirteen</b>	<b>UL Listing</b>
D	Damp Location
W	Wet Location
<b>fourteen</b>	<b>Options</b>
2C	Two-circuit wired
CU	Canadian UL Listing
E1	One lamp emergency ballast
E2	Two lamp emergency ballast
FH	Fuse and holder
NL	Night light, for 7 or 9 W PL bipin
NL-LED	Night light, LED
IMS	Integral Occ Sensor
PS	Security push on/off switch

Modifications are available to meet custom requirements.